

Poplar Lake

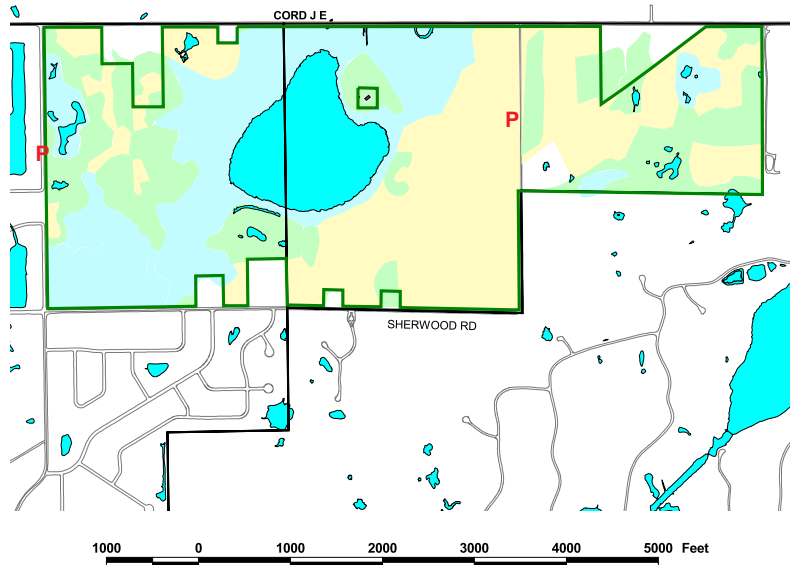

LOCATION: Poplar Lake County Park is located in the north central Ramsey County. It is half in Shoreview and half in White Bear Township. The north boundary is Co. Rd. J and the south boundary is Sherwood Rd. The park is located about midway between I-35 W and I-35E. There are not developed trails or parking in the park. There are a number of foot paths. It is best to park along Sherwood Road across from the County Compost site. MAP #: 7

HABITAT: Poplar Lake is a mixture of wetlands, oldfields and woods. The west side of the park has some of the best oak-aspen woods in the county. The wetlands range from shrub swamp to wet meadow to cattails.

REGULAR BIRDS: Poplar lake has nesting Ospreys, Wild Turkeys, Red-tailed Hawks, Sedge Wrens, and Clay-colored Sparrows. Sandhill Cranes use the wetlands.

CONTACT: Ramsey County Parks and Recreation Department
 2015 N. Van Dyke St.
 Maplewood, MN 55109
 (651) 748-2500
www.co.ramsey.mn.us/parks