

OFFICIAL

COMMON INTEREST COMMUNITY NUMBER 648 A PLANNED COMMUNITY **PHALEN WESTMINSTER CROSSING** FIRST AMENDED COMMON INTEREST COMMUNITY PLAT

This First Amended Common Interest Community Plat is part of the First Amendment to Declaration recorded as Document No. 4067421 on this 15th day of November, 2007 in the office of the COUNTY RECORDER.

This First Amended Common Interest Community Plat is part of the First Amendment to Declaration recorded as Document No. 2023534 on this 15th day of November, 2007 in the office of the REGISTRAR OF TITLES.

DETAIL OF UNITS 1 AND 2

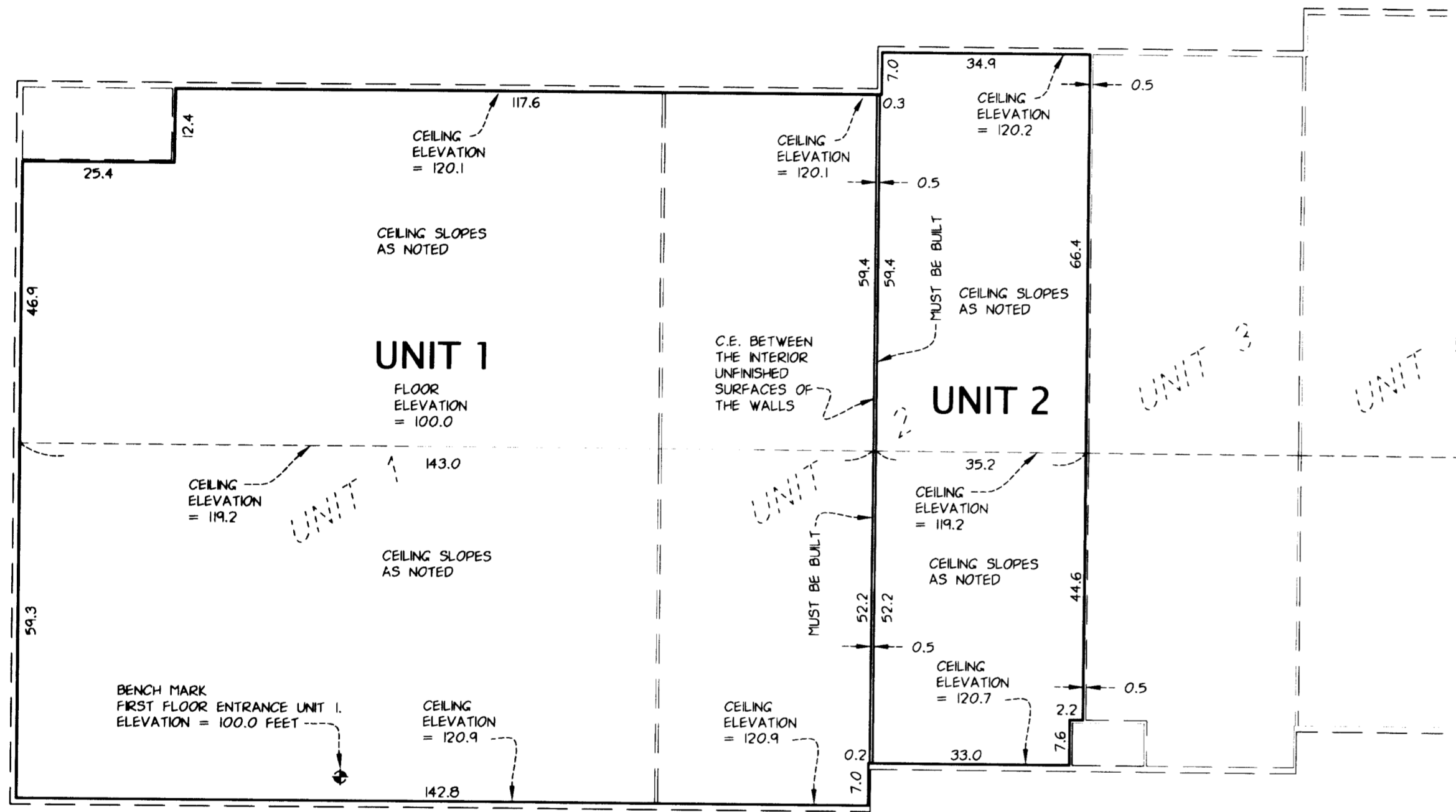

FIRST LEVEL

THE UNITS ON THIS FIRST LEVEL HAVE A FLOOR ELEVATION OF 100.0 FEET
THE UNITS ON THIS FIRST LEVEL HAVE A CEILING ELEVATION THAT VARIES AS SHOWN.

SURVEYOR'S CERTIFICATE

I, Daniel L. Thurmes, do hereby certify that the work was undertaken by or reviewed and approved by me for this FIRST AMENDED COMMON INTEREST COMMUNITY PLAT of COMMON INTEREST COMMUNITY NUMBER 648, A PLANNED COMMUNITY, PHALEN WESTMINSTER CROSSING, being located upon:

Unit 1 and Unit 2 of COMMON INTEREST COMMUNITY NUMBER 648, A PLANNED COMMUNITY, PHALEN WESTMINSTER CROSSING.

Together with:

The common elements between said Units 1 and 2.

fully and accurately depicts all information required by Minnesota Statutes, Section 515B.2-110.

Dated this 20th day of August, 2007.

[Signature]
Daniel L. Thurmes, Land Surveyor
Minnesota License No. 25718

STATE OF MINNESOTA
COUNTY OF WASHINGTON

The foregoing Surveyor's Certificate was acknowledged before me this 20th day of August, 2007, by Daniel L. Thurmes, Land Surveyor.

[Signature]
Connie J. Villari
Notary Public, Dakota County, Minnesota
My Commission Expires Jan. 31st, 2010.

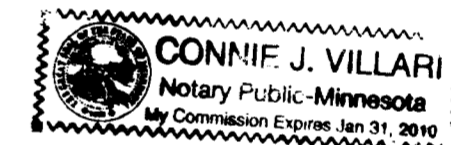

Pursuant to Minnesota Statutes, Chapter 515B, 1-116 and Section 272.12, taxes payable in the year 2007 on real estate hereinbefore described, have been paid, there are no delinquent taxes and transfer entered this 1st day of November, 2007.

[Signature]
David Twa, Director
Property Records and Revenue

By *[Signature]*, Deputy

Pursuant to Minnesota Statutes, Chapter 389.09, Subd. 2, this First Amended Common Interest Community Plat has been reviewed and approved this 13th day of November, 2007.

[Signature]
David D. Claypool, P.L.S.
Ramsey County Surveyor

Suite#B100
200 East Chestnut Street
Stillwater, MN 55082
Phone 651.275.8969
Fax 651.275.8976
dt-cal@
mcleodusa
.net

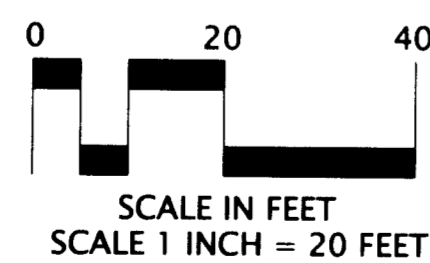

C.E. DENOTES COMMON ELEMENT

BENCH MARK FIRST FLOOR ENTRANCE UNIT 1. ELEVATION = 100.0 FEET (ASSUMED DATUM)

CORNERSTONE
LAND SURVEYING, INC